

SR01 Sealed Rivet

Dome head · Aluminium body · Steel stem · Sealed
3.2 mm (1/8") - 6.4 mm (1/4")

Features

- Fully sealed and weather proof, sealed against moisture air and other contaminants
- Good hole fill and retained stem provide strong vibration resistant joints
- Higher tensile and shear strength than equivalent open end rivets

Material

- Body: Aluminium alloy (AlMg5), polished
- Stem: Steel, phosphated

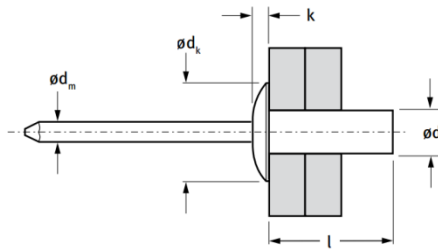

Before Placement

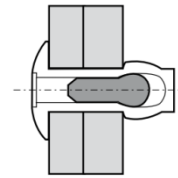

After Placement

Part No.	Size ø	Grip Range		Hole Size	ød	l	ødk	k	ødm	Shear (typical) kN	Tension (typical) kN
		min.	max.								
OSR01-03265	3.2 (1/8")	0.5	2.0	3.3	3.2 [±0.08]	6.5	6.0 [±0.24]	1.4	1.7	1.07	1.25
OSR01-03280		2.0	3.5			8.0					
OSR01-03295		3.5	5.0			9.5					
OSR01-03211		5.0	6.5			10.7					
OSR01-03212		6.5	8.0			12.7					
OSR01-04080	4.0 (5/32")	0.5	3.5	4.1	4.0 [±0.08]	8.0	8.0 [±0.29]	1.7	2.18	1.70	2.24
OSR01-04095		3.5	4.5			9.5					
OSR01-04011		4.5	6.5			11.0					
OSR01-04012		6.5	8.0			12.7					
OSR01-04014		8.0	10.5			15.0					
OSR01-04880	4.8 (3/16")	1.0	3.0	4.9	4.8 [±0.08]	8.0	9.5 [±0.29]	2.0	2.63	2.20	3.10
OSR01-04895		3.0	4.5			9.5					
OSR01-04811		4.5	6.0			11.0					
OSR01-04812		6.0	7.5			12.5					
OSR01-04814		7.5	9.0			14.0					
OSR01-04816		9.0	11.0			16.0					
OSR01-04818		11.0	13.0			18.0					
OSR01-04821		13.0	16.0			21.0					
OSR01-04825	16.0	20.0	25.0								
OSR01-06412	6.4 (1/4")	1.5	6.0	6.5	6.4 [±0.11]	12.5	12.7 [±0.35]	2.5	3.7	3.95	4.90
OSR01-06416		6.0	8.0			16.0					